

# CORNER RESTORATION

**CORNER:** NE Sec 5 TWP. 14S. RANGE 32E.

**ORIGINAL SURVEY BY:** S. W. Lackland

**CONTRACT NUMBER:** 357

**CONTRACT DATE:** July 2, 1880

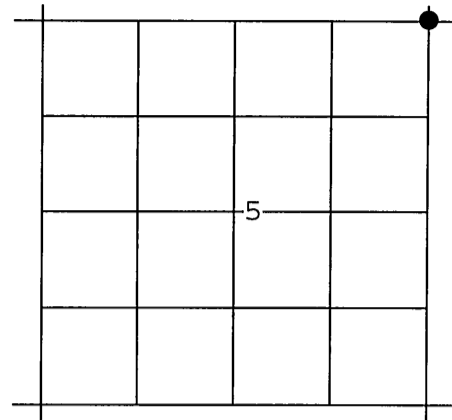

**ORIGINAL DESCRIPTION:** Intersected Township line 44.76 chs west of cor to secs 32 & 33 at which point I set stone 16x12x8 in mound of stone for closing cor to secs 4 & 5.

**RESTORATION BY, STAMP AND DATE:**

R.D. Bagett  
S.D. Follweiler  
M.C. Springer

RECEIVED AND  
FILED

*NOV. 5, 1999*  
OFFICE OF COUNTY SURVEYOR

*Robert D. Bagett*  
ATTEST: *Steven D. Follweiler*

REGISTERED  
PROFESSIONAL  
LAND SURVEYOR

*Robert D. Bagett*  
OREGON  
JULY 12, 1963  
ROBERT D. BAGETT  
598  
RENEWAL DATE 12/31/99

October 15, 1999

Grant County Surveyor

**EVIDENCE FOUND:** Found a stone 16"x13"x8" marked CC laying in a ring of stones.

An East-West fence is 5 feet south.

**DESCRIPTION OF MONUMENTS AND ACCESSORIES SET AND METHODS USED:**

Show how trees are scribed and basis of bearings, including compass var.

At the corner point: I set a 1½"x30" galv. iron pipe, 24" in the ground, with attached Grant County Surveyor brass cap marked as shown.

From which I SCRIBE NEW BEARING TREES:

- A Ponderosa pine 7"diam., bears N54°E, 44.3 ft. marked X CSBT.
- A Ponderosa pine 16"diam., bears S58°E, 50.1 ft. marked T14S R32E S4 CC CSBT.
- A Ponderosa pine 22"diam., bears S30°W, 34.8 ft. marked T14S R32E S5 CC CSBT.
- A Ponderosa pine 9"diam., bears N29°W, 36.5 ft. marked X CSBT.

**MONUMENT MARKED**

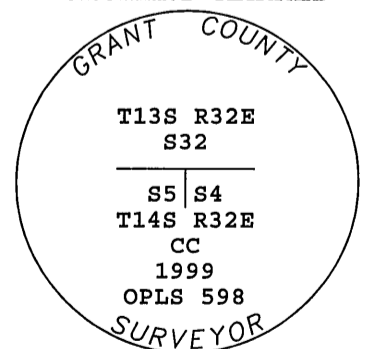

Buried marked stone southeast and alongside iron pipe, raised a mound of stone 3 ft. base to top of cap. Used mag. compass with 18°E var. and a steel tape, measuring to a 50d nail driven in the sidecenter at the root crown of the BT's. Attached BT tags to BT's.